

Tailback56

Universal Back Brace Instructions for Use



MANAMED™

1511 W. Alton Ave.,
Santa Ana CA 92704
888-508-0712
www.ManaMed.Net

Sizing

Tailback can be adjusted from 25" to 68".

Tailback comes with a main panel and two adjustable belts with comfort pull rings. Simply place the fullback on a table with the inside facing up. When using each matching number, the waist is measured as the following:

S & S = 25" - 32" waist	2XL & 2XL = 50" - 56" waist
M & M = 32" - 38" waist	3XL & 3XL = 56" - 62" waist
L & L = 38" - 44" waist	4XL & 4XL = 62" - 68" waist
XL & XL = 44" - 50" waist	



Step 1 Match the size using the chart to fit your waist match your belts size. Remove Velcro from belts and pull the tabs through to the sizing creases, securing the sizing flap with Velcro to your appropriate crease 1,2,3,4,5,6,7. For your appropriate size, see chart above and reference **Sizing** box to the left (in blue).

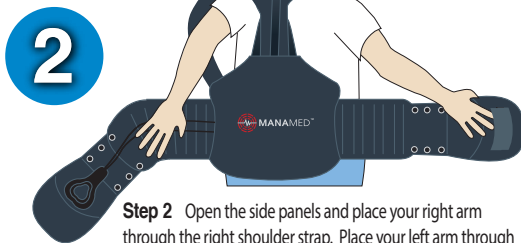

Step 2 Open the side panels and place your right arm through the right shoulder strap. Place your left arm through the left shoulder strap, very similar to putting on a backpack.

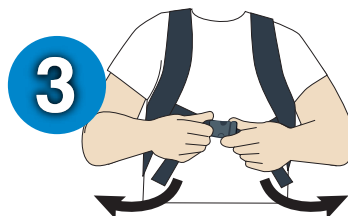

Step 3 Using the quick-snap, attach the stern strap and adjust as needed. Make any adjustments to the shoulder straps; making sure the brace fits snug. Re-adjust side panels and compression straps as needed.



Step 4 Making sure the back panel is centered, wrap the left side panel around to the abdomen and hold in place. Wrap the right side panel around to the abdomen and attach to the left panel.

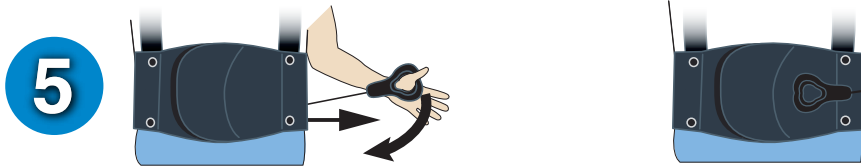

Step 5 Pull both comfort rings forward until you feel comfortable and then secure the rings to your brace by placing them on to the sides. The comfort rings control the compression of the brace and can be used to adjust the fit.



Step 6 (optional) Optional Lateral panels. If you are instructed to use the Lateral panels secure them to inside of the brace by placing them next to the main panel with the large curve resting next to the main panel on both sides.



Removing the brace Lift both comfort rings off the brace placing them to the sides and securing them so there is no tension on the brace. Then remove the Velcro connection on the front panel, undo the buckle straps for chest and shoulders and safely remove the brace.

Ice Pack:
This can
velcro into
the brace



Caution! Please read carefully prior to product use:

Always follow your health care professional's specific treatment instructions. Supervision is advised when applying this product on geriatric patients and children. Never apply ice pack(s) directly to skin. As an additional protective barrier such as a cloth towel is recommended to protect against frostbite to the affected area. In the unlikely event there is exposure to the eyes, immediately flush with water and consult with a healthcare professional as a precaution. If ice pack is punctured, dispose of it and reorder a replacement to continue treatment.

Application instructions

Place ice pack(s) into the freezer for at least 4 hours before using. Place the ice pack into pouch and seal shut. Apply to affected area. Remove pack if it becomes uncomfortable. Always follow your healthcare professional's or physician's specific treatment instructions.

CE Tailback Brace is a universal lumbosacral orthosis with removable anterior and lateral panels. When properly configured, the Tailback fits the description of the L0456.

LIMITED WARRANTY

Manamed warrants to the original purchaser that this product is free from defects in materials and workmanship. Normal wear and tear during the use of a product is not considered a defect. This Limited Warranty is effective from the date of delivery to the original purchaser. This warranty does not apply if this product has been altered in any way; was not purchased from Manamed or one of its authorized distributors; is not used in accordance with Manamed Instructions for Use (IFU). Under this Limited Warranty Manamed's sole obligation shall be to repair or replace the defective product or associated part(s) at no charge. This Limited Warranty does not cover damage as a result of mishandling, accidents, improper use or alteration of the product. This warranty is in place of all other warranties, either express or implied, including but not limited to warranties of merchantability or fitness for a particular purpose. Manamed shall not be liable under this or any implied warranty for any personal injury, property damage, or special, incidental, or consequential damages arising out of, related, or incidental to the use of the product even if Manamed has been informed of the prospect of such possible loss or damage, unless state law otherwise prohibits this exclusion. User should seek advice from their healthcare provider immediately if user encounters any kind of adverse reaction related to the use of this product. User should consult with their healthcare provider with any questions or concerns relating to the proper use of this product for their specific medical condition. **IMPORTANT- Read all Instructions for Use (IFU) and any other associated materials to ensure proper use.**